

Breville®

Turn **on** your creativity®



BLEND *ACTIVE*®

Personal Blender

product safety

READ CAREFULLY AND KEEP FOR FUTURE REFERENCE

This product can be used by children aged 8 years and above, and persons who require supervision, provided:

- **they are familiar with the hazards associated with the product, and,**
- **they receive instruction by a competent person on how to safely use the product.**

Children must not play with the product. Cleaning and user maintenance must not be done by children unless they are aged 8 or older and are supervised.

Always disconnect the appliance from the mains supply socket if it is left unattended and before assembling, disassembling or cleaning.

If the supply cord is damaged, it must be replaced by the manufacturer, its service agent or similarly qualified persons in order to avoid a hazard.

- ⚠ Never use this appliance for anything other than its intended use. This appliance is for household use only. Do not use this appliance outdoors.
- ⚠ Always ensure that hands are dry before handling the plug or switching on the appliance.
- ⚠ Always use the appliance on a stable, secure, dry and level surface.
- ⚠ This appliance must not be placed on or near any potentially hot surfaces (such as a gas or electric hob).
- ⚠ Never immerse any part of the appliance or power cord and plug in water or any other liquid.
- ⚠ Never let the power cord hang over the edge of a work top, touch hot surfaces or become knotted, trapped or pinched.
- ⚠ Do not use the appliance if it has been dropped or if there are any visible signs of damage or if it is leaking.
- ⚠ Never use any accessory or attachment not recommended by the manufacturer.
- ⚠ Make sure that all attachments are securely and correctly fitted before operating the appliance.
- ⚠ The blades have very sharp edges. Take care when handling or cleaning them.
- ⚠ Allow moving parts to come to a stop before changing or cleaning accessories.
- ⚠ Never process hot or boiling liquids. Allow them to cool before processing.

before using

⚠ Ensure that the appliance is switched off and unplugged from the supply socket if it is left unattended and before assembling, disassembling or cleaning.

The blades have very sharp edges. Take care when handling or cleaning them.

Never immerse any part of the appliance or power cord and plug in water or any other liquid.

Never use harsh, abrasive or caustic cleaners to clean this appliance.

1. Remove your Blend Active carefully from the box. You may wish to store the packaging for future use.
2. Check the contents:
 - Motor unit
 - Blade assembly
 - Bottle (x2)
 - Resealable lid (x2)
3. Wash all parts that will come into contact with food. Use warm soapy water then rinse and dry thoroughly.
4. Using a mild detergent solution, wipe the motor unit with a damp cloth. Dry thoroughly.

features

1. Drink Bottle Lid (x 2)

The lid can be stored on the base of the bottle. Dishwasher safe.

2. 600ml Sport Bottle (x 2)

The BPA free bottle allows you to blend your favourite smoothies or drinks, and then take it with you. Dishwasher safe.

3. Blade Assembly

The durable stainless steel blades produce smooth consistent results for your Smoothies and Milk Shakes. Dishwasher safe.

4. One touch blending action

The one touch blend button provides short bursts of power for control when blending.

5. Blender Base

The base houses a 350 watt motor for great performance for any blending task.

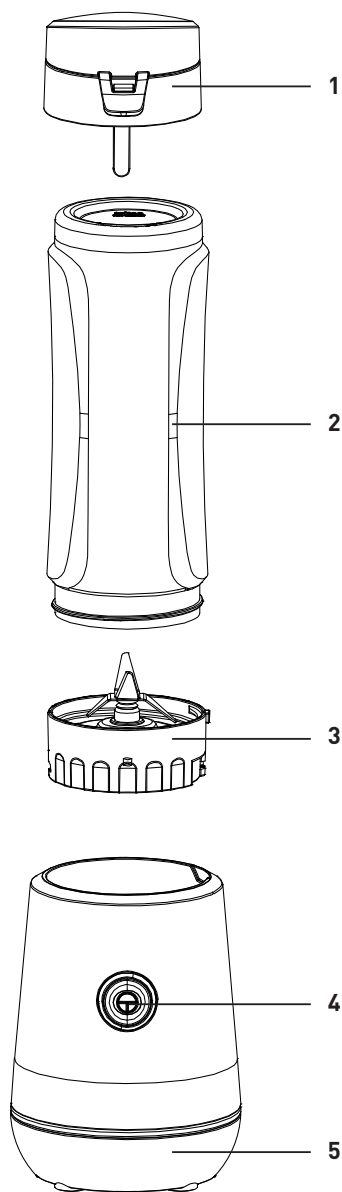

Due to our policy of continuous improvement, the actual product may differ slightly from the one illustrated in these instructions.

using your Blend Active

▲ Ensure that the appliance is switched off and unplugged from the supply socket if it is left unattended and before assembling, disassembling or cleaning. The blades have very sharp edges. Take care when handling or cleaning them. Never attempt to fit the blade assembly onto the motor unit by itself. Do not operate your Blend Active continuously for more than 30 seconds without giving it a rest period of one minute. Your Blend Active is not suitable for processing hot food.

1. Add the ingredients to the bottle. Don't fill the bottle above the 600ml mark.
2. Fit the blade assembly onto the bottle. Tighten the blade assembly firmly. See figure 1.
3. Turn the bottle upside down so that the blade assembly is at the bottom. See figure 2.
4. Line up the ▼ symbol on the blade assembly with the ▲ symbol on the rim of the motor unit. Gently press the bottle downwards then twist it clockwise to lock the bottle in place. See figure 3. Your blender will not work unless the bottle is correctly locked into position.
5. Press and hold the blend button to operate your blender. You can either press and hold the button or use short pulses until your drink is at the desired consistency.
6. When you have finished blending your drink, and the blades have stopped rotating, twist the bottle anticlockwise to remove the bottle and blade assembly. Turn the bottle the right side up then unscrew the blade assembly and fit one of the resealable lids onto the bottle. Close the cap of the resealable lid firmly until it 'clicks'. See figure 4.

Notes: If the ingredients become stuck around the blade during processing, simply remove the bottle from the motor unit, give it a shake then refit it and carry on processing. Always remove the bottle when attempting to agitate or otherwise redistribute the ingredients. For ease of cleaning, we recommend that you clean your blend active bottle and cap as soon as you have finished using them.

Crushing ice

Your blender can be used to crush ice. For best results and to prevent possible damage to the blades, always add a small amount of liquid to the ice before processing. The liquid can be water or one of the liquid ingredients from your recipe (fruit juice, etc.).

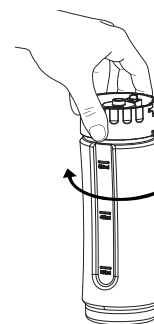

Figure 1



Figure 2

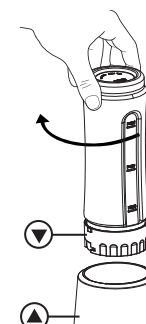

Figure 3

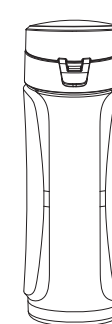

Figure 4

Notes

- All recipes make 1 serving.
- Smoothies and shakes often separate if not consumed immediately after blending. However, they can be re-blended and consumed within 30 minutes if necessary.

Ingredients

- Peanut butter—a great protein shake ingredient. Try and source an unsweetened variety.
- Frozen berries—now widely available in larger supermarkets. Look out for special packs of frozen smoothie mixes too.
- Protein powder—a concentrated form of protein. Used as a dietary supplement, protein powder can be added to drinks, sprinkled on cereal, stirred into soups and stews, or cooked into baked goods and other meals. Available from most large supermarkets or health shops.
- Almond Milk—a healthy alternative to cow's milk.
- Soya Milk—can be used as a skimmed milk replacement in all of our recipes.

PROTEIN SHAKES

Protein Rich Shake

- 300ml skimmed milk
- 2 tbsp unsweetened peanut butter
- 1 small ripe banana, broken into chunks
- 1 large handful of frozen berries
- 2 tbsp oatmeal

Good Morning

- 300ml skimmed milk
- 1 tsp instant coffee
- 30g Vanilla protein powder

Berry Blitz

- 1 large handful of frozen or fresh berries
- 30g vanilla protein powder
- 300ml skimmed milk
- 6 ice cubes

Chocolate and Banana

- 300ml skimmed milk
- 1 tbsp unsweetened peanut butter
- 30g chocolate protein powder
- 1 small ripe banana

SMOOTHIES

Super Thick Berry

- 300ml chilled apple juice
- 100ml plain natural yoghurt
- 1 small ripe banana
- 1 handful of frozen berries
- 1 tbsp honey (optional)

Tropical Fruit

- 1 small ripe mango, peeled and diced
- 1 kiwi fruit, peeled and cut into chunks
- 1 passion fruit, seeds scooped out
- 200ml of light coconut milk
- 100ml concentrated tropical juice
- Juice of half a lime
- Handful of ice

Raspberry Crush

- 300ml chilled freshly squeezed orange juice
- 1 handful of fresh or frozen raspberries
- 75g raspberry sorbet
- Mint leaves to garnish

Kiwi and Berry Bliss

- 1 large handful of frozen berries or blueberries
- 1 kiwi fruit, peeled and diced
- 1 small banana, peeled and broken into chunks
- 300ml fresh fruit juice

DAIRY-FREE SMOOTHIES

Berry Blend

- 300ml chilled almond milk
- 1 small ripe mango
- 1 small banana
- 1 handful of fresh or frozen berries

Soya Smoothie

- 300ml chilled soya milk
- 20g porridge oats
- 1 small banana, peeled and cut into chunks
- 7 large strawberries
- Few drops of vanilla extract
- 1 tbsp honey

CARROT, ORANGE AND GINGER JUICE

- ½ inch fresh root ginger, peeled and finely sliced
- 1 medium sized carrot, scrubbed and finely sliced
- 1 large orange, peeled and chopped
- 300ml chilled fresh orange or carrot juice
- 6 ice cubes

cleaning and storage

⚠ Ensure that the appliance is switched off and unplugged from the supply socket if it is left unattended and before assembling, disassembling or cleaning.

Never immerse the motor unit or power cord and plug in water or any other liquid.

Never use harsh, abrasive or caustic cleaners to clean this appliance.

The blades have very sharp edges. Take care when handling or cleaning them.

Cleaning

- Clean the motor unit with a damp cloth only.
- Wash the blade assembly in warm, soapy water. Rinse and dry thoroughly. For stubborn food deposits stuck around the blade, carefully use a washing up brush. Alternatively, the blade assembly can be washed in a dishwasher.
- Wash the bottles and lids in warm, soapy water. Rinse and dry thoroughly. Alternatively, the bottles and lids can be washed in a dishwasher.

Quick cleaning method

1. Half fill a bottle with warm water and a drop or two of detergent. Fit the blade assembly and fit them both into the motor body as described in the section *using your Blend Active*.
2. Press and hold the blend button for 10-20 seconds.
3. Remove the bottle, unscrew the blade assembly and rinse them both under running water.

Storing

Store your Blend Active in its packing or in a clean, dry place. Ensure all parts are dismantled and keep the appliance out of the reach of children.

Troubleshooting

For Troubleshooting and FAQs visit www.breville.co.uk

after sales service

In the case the appliance does not operate but is under warranty, return the product to the place it was purchased for a replacement. Please be aware that a valid form of proof of purchase will be required. For additional support, please contact our Consumer Service Department at **0800 028 7154** or email: **BrevilleEurope@newellco.com**.

replacement parts

For additional or replacement bottles, please visit www.breville.co.uk or call us on **0800 028 7154**.

electrical safety

If the plug is not suitable for the socket outlets in your home, it can be removed and replaced by a plug of the correct type.

If the fuse in a moulded plug needs to be changed, the fuse cover must be refitted. The appliance must not be used without the fuse cover fitted.

If the plug fuse requires replacement, a fuse of the same rating as that fitted by the manufacturer must be used. In order to prevent a hazard do not fit a fuse of a lower or higher rating.

If the terminals in the plug are not marked or if you are unsure about the installation of the plug please contact a qualified electrician.

CAUTION: DO NOT CONNECT EITHER WIRE TO THE EARTH TERMINAL IN THE PLUG WHICH IS MARKED E OR WITH THE EARTH SYMBOL (⏏) OR COLOURED GREEN OR GREEN AND YELLOW.



This symbol indicates that this unit is a Class II appliance and therefore an earth connection is not required.

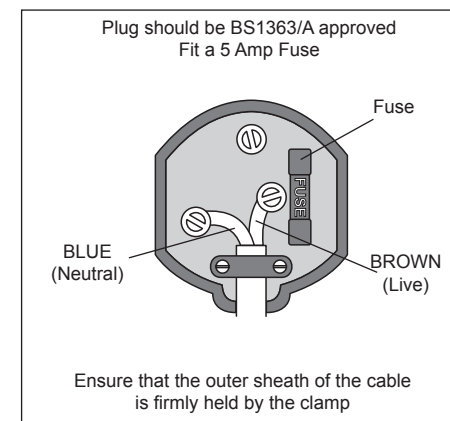

waste disposal

Waste electrical products should not be disposed of with household waste. Please recycle where facilities exist. E-mail us at BrevilleEurope@newellco.com for further recycling and WEEE information.

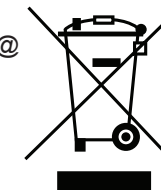



Newell Brands UK Limited.
5400 Lakeside, Cheadle Royal Business Park,
Cheadle, SK8 3GQ, United Kingdom
Newell Poland Services Sp. z o.o.,
Plac Andersa 7, Poznan, 61-894, Poland.
e-mail: BrevilleEurope@newellco.com
UK Telephone: 0800 028 7154



www.breville.co.uk

© 2022 Newell Brands UK Limited. All rights reserved.
Newell Brands UK Limited, 5400 Lakeside, Cheadle Royal Business Park, Cheadle, Cheshire, SK8 3GQ,
United Kingdom. Newell Poland Services Sp. z o.o., Plac Andersa 7, Poznan, 61-894, Poland.
Newell Brands UK Limited and Newell Poland Services Sp. z o.o. are subsidiaries of Newell Brands Inc.
The product you buy may differ slightly from the one shown on this carton due to continuing product
development.

Printed in China.